

# Capital Projects

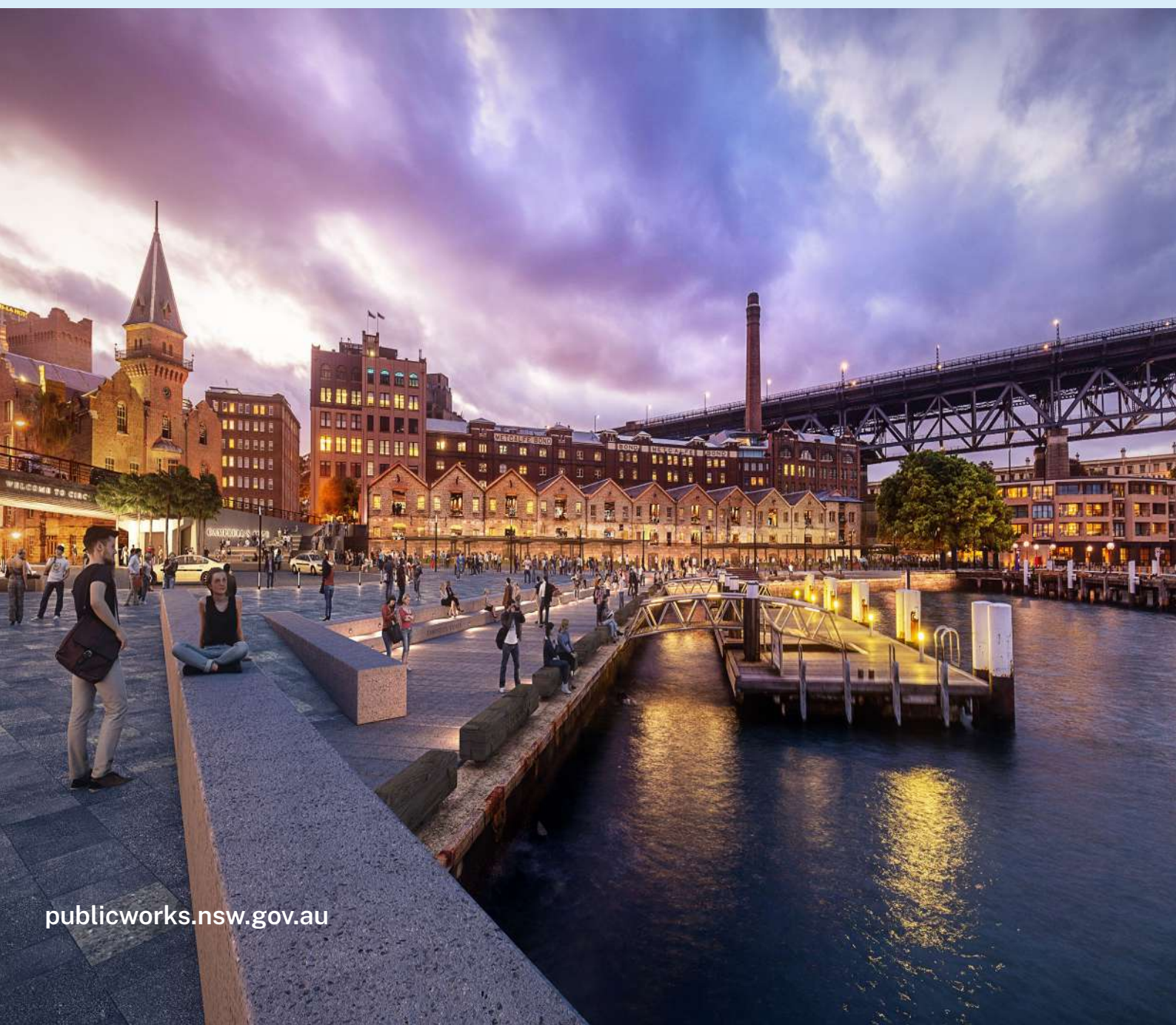





---

## Capital Projects

NSW Public Works has a state-wide team of expert project managers providing assurance, development and construction delivery solutions for Government agencies and Local Government infrastructure assets.

Our project managers can provide a diverse range of professional services, including asset management advice, project initiation, consultant management, procurement, construction contract management and commissioning. We have established processes and governance arrangements in place to advise on the management of minor and major capital works projects and state-wide programs of work.

We consult with clients on their project risks and work with the key stakeholders to achieve a 360 degree risk profile with management strategies.

As the project develops the Risk Register is re-assessed and updated at each key milestone.

Under the NSW Government Construction Procurement Operating Model, NSWPW can provide Procurement Assurance Services to unaccredited agencies to facilitate the delivery of their Capital Projects valued over \$1.3M.

**Peter Hogan**

0438 283 826

[peter.hogan@pwa.nsw.gov.au](mailto:peter.hogan@pwa.nsw.gov.au)

---

# Our Expertise

---

NSW Public Works provides a comprehensive range of **project and program management services** tailored to NSW Government and Local Council infrastructure projects.

---



- Program and project management
- Commercial advice & procurement of consultants & building contractors
- Collaborate with our clients, manage stakeholders & participate in community consultation
- Establish project budgets, leading value management & maintain cost control
- Management of design & technical consultants
- Expert contract management
- Assess, monitor, manage report on project risks in accordance with current ISO standards
- Review, monitor & report on project Quality, Safety & Environment requirements
- Creating public value



# Batemans Bay Regional Aquatic, Arts & Leisure

This project is a unique regional development for Eurobodalla Shire Council (ESC), bringing together an aquatic centre with four water bodies and two external water play slides, a 350 seat theatre with full supporting professional amenities, gym and associated treatment rooms, a regional gallery space, retail space and a cafe.

NSW Public Works were involved in the procurement of the Principal Design Consultant (PDC), management of the PDC, design and budget development, procurement of the builder through a public EOI and early tenderer involvement process and have been appointed to project manage the construction delivery.

Working closely with the ESC leadership team and extensive community engagement work undertaken in the pre-design phase is contributing to the success of the project.



## Chief Secretary's Building

The Chief Secretary's Building was constructed in the late 1800's and due to its significance is listed on the State Heritage Register.

Due to the failure of the ceiling's existing lath and plaster, NSW Public Works were engaged to project manage the repair and re-painting. The intent of this project was to ensure repairs were completed to conserve the existing features.

A highly refined strategic methodology was followed which included cataloguing and removing all cultural artifacts from the rooms and then replacing them post works. We consulted with heritage architects, plasterers, paint experts and industry professionals to deliver this exquisite restoration.



# Anzac Park Public School

Anzac Park Public School was built on a small lower North Shore site and was one of the first schools in NSW to explore a contemporary approach to medium rise school design.

The project included the delivery of 39 general learning spaces, two special education learning spaces, four special programs rooms, a communal hall, a library, administration and staff facilities, student facilities, a canteen, stores and auxiliary facilities. There is also a kiss and drop lane at the school entry, a covered outdoor learning area, a games court and running track, roof top play and educational space, free play and passive play areas and a agricultural terrace with a garden shed and planting areas.

The updated streetscape included the reinstatement of the building's awning and street columns, decorative cast iron columns, brackets and frieze and multi-faceted timber parapet.



# Dubbo Zoo African Waterhole Cafe

NSW Public Works were engaged to project manage the procurement and construction of the new African Waterhole Cafe on behalf of the Taronga Conservation Society of Australia. This adventure cafe caters for one hundred and fifty seats with a commercial kitchen, has three dining areas, a central tortoise exhibit, amenities and a commanding view across the immediate surroundings.

The popular Waterhole Cafe is situated at the halfway point of the zoo circuit overlooking a number of herd species with blackbuck and zebra prominent as well as other integrated animal exhibits.

The African Waterhole Cafe facility includes extensive hard and soft landscaping, two kilometers of animal raceways and a hoofed mammal handling yard.





# Campbells Cove

## The Rocks

The recent redevelopment of Campbells Cove will conserve the heritage fabric of the area while improving the promenade to create the largest public gathering space in The Rocks. The promenade links Circular Quay to Walsh Bay and complements the heritage upgrade and links to the Overseas Passenger Terminal, which has become a major tourist arrival point for Sydney.

The redevelopment at Campbells Cove includes a leveling and widening to 10-metres of the existing promenade, a waterfront leisure area and amphitheatre for public events, and east-west connections from the promenade to Hickson Road and The Rocks.

NSW Public Works role was to manage the design phase to deliver the project. The project won a Tourism Award in the 2019 Australian Institute of Landscape Architects awards.



# Parramatta North

## Heritage Precinct

This project will be developed in stages, commencing with works to enable decanting of existing tenants into other buildings across the precinct, to make way for the proposed Western Sydney Startup Hub.

Works include office refurbishments to accommodate staff in three separate locations within the site and roof repairs to heritage buildings. Other works include demolition of redundant, non-significant buildings, site remediation and building repairs, office fitouts and soft and hard landscaping.

The adaptation and re-use of existing heritage buildings will include undertaking essential conservation works, reconstructing demolished elements, removal of modern additions and the introduction of new building elements and services. NSW Public Works have been engaged to manage the procurement and the construction delivery.



# Toormina Public School Access Integration

NSW Public Works were selected by the Department of Education to provide project management services for the design, procurement and contract management for provision of AS1428-compliant access throughout Toormina Public School.

Areas of the proposed walkways and ramps bisected precincts of native vegetation. We engaged and managed an experienced environmental consultant to conduct a comprehensive Review of Environmental Factors to ensure that the project was delivered in a sustainable and conscientious manner.

The project incorporated extensive stakeholder engagement, coordination of site access provisions and dynamic management of construction activities to ensure staff, students and the public could continue to access the school with limited encumbrance.



## NSW Public Works Assisting in Delivering Statewide Building Programs

- Department of Primary Industries Food and Fibre Stages 1 and 2 Regional Institutes Upgrade
- Property NSW Maintenance & Upgrade Program
- Legal Aid Office Refurbishment Program
- State Archives & Records Authority of NSW Maintenance and Upgrade Program
- Schools Infrastructure NSW Cooler Classrooms School Air Conditioning Program
- NSW Disaster Relief –Home Rebuild Program
- Aboriginal Housing Office Residential Program
- Teacher Housing Authority Program
- Crown Lands Showground Maintenance Program
- Coastal Infrastructure Upgrade Program



# Powerhouse Museum Discovery Centre

The proposed expansion of the Museum’s Discovery Centre in Castle Hill will allow the whole Powerhouse Collection to be stored on one site when not on display or loan, greatly improving community access to the Collection. This is part of the broader program to renew and transform the Powerhouse, one of Australia’s most significant cultural institutions.

A new state-of-the-art building will be constructed on the site, and will include spaces for the storage, care, research and viewing of the Powerhouse Collection, as well as flexible spaces for education and public programs, workshops, talks and events.

The proposed expansion will provide greater access to the Powerhouse Collection for the people of Castle Hill and broader Sydney community. NSW Public Works have been engaged to assist in finalisation of the design development and manage the procurement and construction delivery.



## 231 Elizabeth Street Sydney CBD

NSW Public Works were engaged in an advisory role, which included developing the risk management profile on the construction delivery of the project as well as assisting Property NSW with managing the risk associated with distinct development. We provided advice throughout the project on the ongoing time management, design and variation costs and critical design and building services decisions.

The fitout project comprised 15 floors and was a high-end quality finish in Sydney’s CBD. Unique solutions were identified and implemented for a very complex floor plan.

The project was delivered successfully in a very challenging COVID-19 environment, by an exceptional team across government and the private sector.

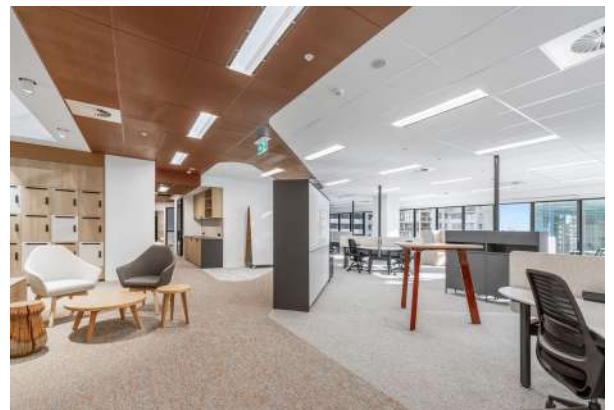



# Yawarra Community School Swimming Pool

The Yawarra Community School, which derives its name from the Wiradjuri word for “to take care of”, is located in Dubbo and provides specialist education to support students with a range of disabilities. Some of the services that are available to support the children include personalised learning and the services provided by speech and occupational therapists.

The Department of Education recognising the important work undertaken at the school, provided funding for a new \$4.5M million hydrotherapy pool to enhance the quality of life for the students and the community.

NSW Public Works were engaged to project manage the works which were procured using a design and construct contract. The project was successfully delivered by a regional builder who employed fifty three local trades people and sourced building materials from local suppliers.



# Registrar General's Building

Property NSW commissioned NSW Public Works to replace the roof of the Registrar General's Building located on Prince Albert Road in the Sydney CBD. The building was constructed between 1903-1956 and is a sandstone building in the Federation 'Tudor' Gothic Revival style and is of state heritage significance.

The project was extremely complex due to the compressed 6 month construction program and further complicated by the onset of the COVID-19 pandemic in March 2020 which resulted in restrictions on the construction works and slate delivery delays. The quality of works was maintained under close scrutiny of the heritage architect and other consultants.

We managed the design phase of the project, procured the slate and tendered the roofing works within the original construction program and budget.



# Why Choose NSW Public Works?



## Accredited for planning and delivery of capital works

NSW Public Works is accredited under the NSW Government Agency Accreditation Scheme for Construction to manage the planning and delivery phases of construction and capital works procurement. NSW State and Local Government entities can directly engage the services of NSW Public Works under the provision of NSW Government Procurement Board Direction PBD 2020-04 and Section 55 of the Local Government Act 1993, providing efficiencies and cost savings.



## Strong focus on quality, environmental and safety management

NSW Public Works operates under triple certification for quality, occupational health and safety (WHS) and environmental (QSE) management systems. These systems and processes provide the foundation for delivering quality projects and a continuous improvement culture, that embraces QSE leadership at all levels and integrates QSE into all activities. NSW Public Works' Project Management Framework is the backbone of our quality system and is used to manage our projects and ensure we deliver to agreed requirements.



## State-wide resources

Regional clients benefit from our state-wide network of offices enabling them to source expert project management personnel familiar with the conditions and construction industry issues in their area. This proximity reduces servicing costs, facilitates improved stakeholder communications and enables us to respond quickly to your needs, providing a single point of contact for all services.



## Government relationships and knowledge

Successful delivery of complex infrastructure projects relies on effective interaction with stakeholders and regulatory government agencies. NSW Public Works' unique position within NSW Government enables us to bridge the gap between our clients and Government stakeholders to ensure necessary consultations and approvals are undertaken efficiently and effectively.



## Managed risks

We place considerable emphasis on advising clients of their risks on projects, including the options and costs to manage these risks. Wherever possible, risks are identified early and inform our planning and procurement strategy development processes. Risks are continuously monitored and updated as projects progress and discussed and managed with clients and contractors.



# Working across NSW

## HUNTER NEW ENGLAND REGION

**Newcastle**  
117 Bull Street  
Newcastle West NSW 2302

**Tamworth**  
155-157 Marius Street  
Tamworth NSW 2340

**Inverell**  
240 Byron St  
Inverell NSW 2360

**Armidale**  
85 Faulkner St  
Armidale NSW 2350

## NORTH COAST REGION

**Lismore**  
120 Dally Street  
Lismore NSW 2480

**Coffs Harbour**  
359 Harbour Drive  
Coffs Harbour NSW 2450

**Port Macquarie**  
Level 2, 41-47 Horton Street  
Port Macquarie NSW 2444

## SYDNEY METRO

**Parramatta**  
4 Parramatta Square  
12 Darcy Street  
Parramatta NSW 2150

**The Rocks**  
66 Harington Street  
Sydney NSW 2000

## SOUTH COAST REGION

**Wollongong**  
Level 3, Block E  
84 Crown Street  
Wollongong NSW 2500

**Goulburn**  
Suite 5, 167 Auburn Street  
Goulburn NSW 2580

**Moruya**  
66 Campbell Street  
Moruya NSW 2537

**Queanbeyan**  
Ground Floor East  
11 Farrer Place  
Queanbeyan 2620

## RIVERINA/WESTERN

**Bathurst**  
Level 1, 346 Panorama Avenue  
Bathurst NSW 2795

**Dubbo**  
34 White Street  
Dubbo NSW 2830

**Broken Hill**  
Level 1, 32 Sulphide Street  
Broken Hill NSW 2880

**Griffith**  
104 - 110 Banna Avenue  
Griffith NSW 2680

**Wagga Wagga**  
2-6 Coleman Street  
Wagga Wagga NSW 2650

**Dareton**  
1998 Silver City Highway  
Dareton NSW 2717



---

**T** 1300 00 88 88  
**E** [publicworks@pwa.nsw.gov.au](mailto:publicworks@pwa.nsw.gov.au)